

400 Union Bower Court, Irving, TX

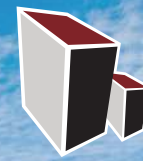

ML REALTY
PARTNERS



14,195 SF AVAILABLE

Building Specifications

Building Size:	58,540 SF
Total Available:	14,195 SF
Office:	377 SF
Clear Height:	19' Clear
Loading:	4 Dock High Doors
Drive In Doors:	2
Electric:	400 Amps, 208/240 Volts, 3-Phase
Car Parking:	Ample
Column Spacing:	32' x 37'
Sprinkler System:	Yes

Building Features

- › Strategically located in the South Stemmons Corridor offering first-class image and environment
- › Easy access to major thoroughfares
- › Professionally landscaped

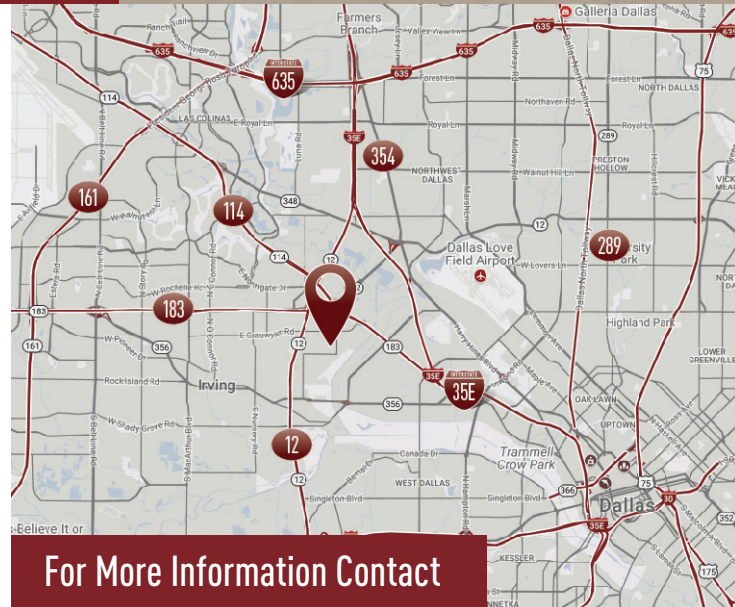

For More Information Contact



CANON SHOULTS
972-280-8328
cshoultst@hldallas.com

ANDREW GILBERT
972-280-8312
agilbert@hldallas.com

Owner:
ML Realty Partners \ \ 8150 N Central Expy, Suite M-2140, Dallas, TX 75206 \ \ 214-389-1155
Information contained herein is subject to change and verification, and no liability for errors or omissions is assumed. © 2017 All Rights Reserved. ML Realty Partners

400 Union Bower Court, Irving, TX

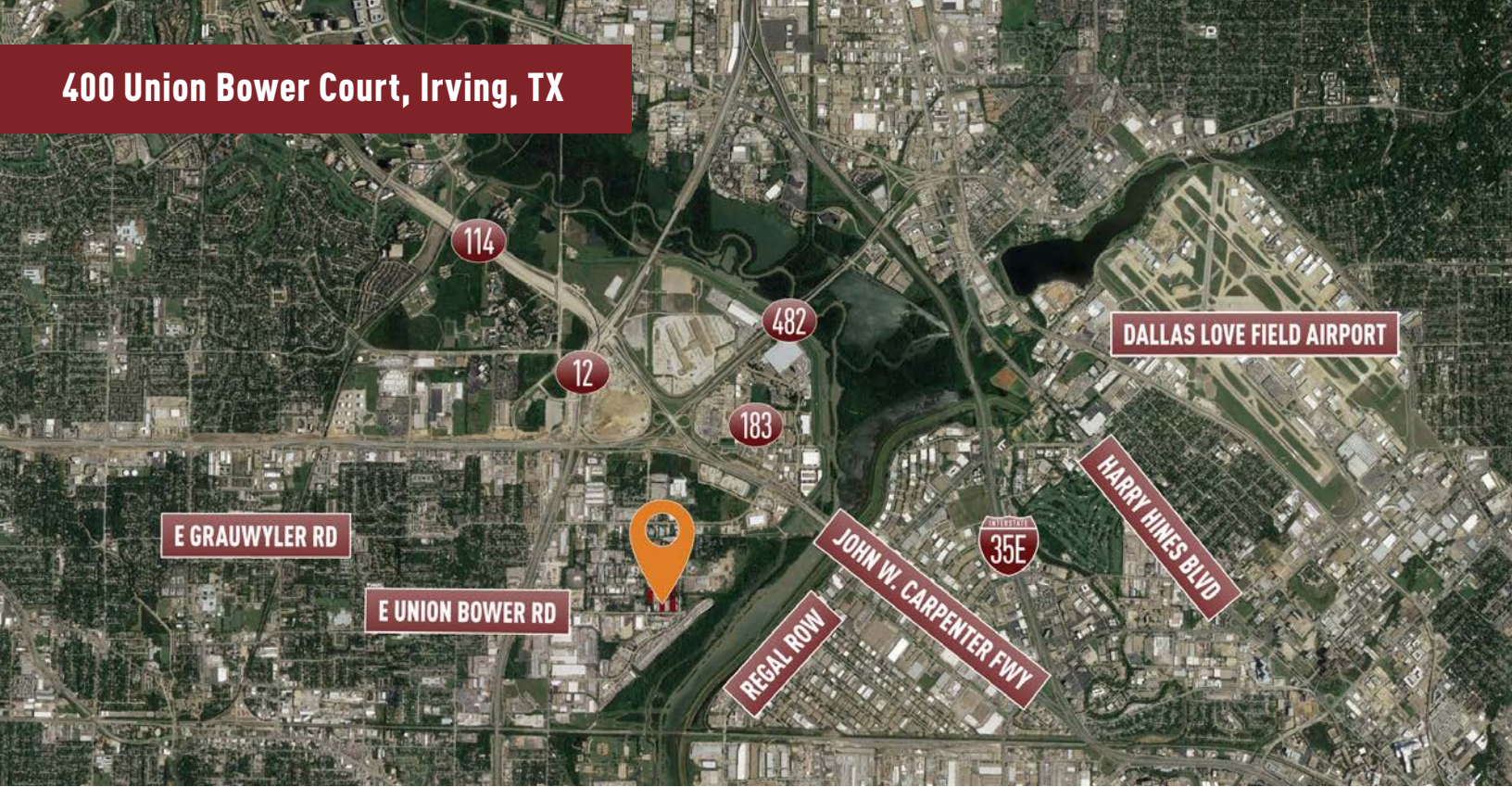

Master Plan Rendering

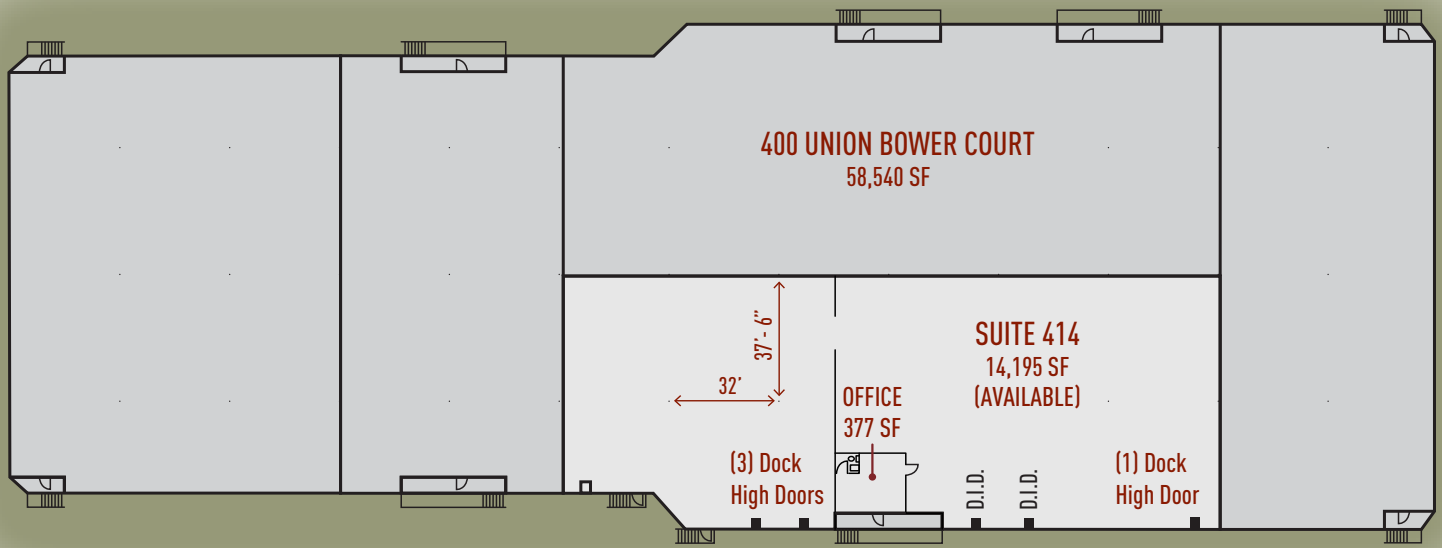

NORTH →



ML Realty Partners \ 8150 N Central Expy, Suite M-2140, Dallas, TX 75206 \ 214-389-1155

Information contained herein is subject to change and verification, and no liability for errors or omissions is assumed. © 2017 All Rights Reserved. ML Realty Partners