

## Heritage Crossing #7

14746 S. Gougar Road, Lockport, IL



ML REALTY  
PARTNERS

FULLY SECURED CROSS-DOCK WITH 100 TRAILERS



# 363,224 SF AVAILABLE

HERITAGE  
CROSSING

### Building Specifications

Building Size:	363,224 SF
Main Office:	3,281 SF
Warehouse Break Room:	3,517 SF
Secondary Office:	4,290 SF
Warehouse Cafeteria:	5,218 SF
Shipping Office:	1,655 SF
Clear Height:	36' Clear
Loading:	64 Exterior Truck Docks (Expandable)
Drive In Doors:	4
Electric:	2,500 Amps, 277/480 Volts (Expandable)
Lighting:	T5
Car Parking:	344 Spaces
Trailer Parking:	Up to 100 Stalls On Site
Column Spacing:	50' x 48', with a 60' speed bay
Sprinkler System:	ESFR

### Building Features

- › Immediate access to I-355 via 143rd Street
- › Building signage on I-355
- › Low Will County real estate taxes
- › Fully secured site with guard shacks
- › Multiple warehouse break rooms and bathrooms
- › Secured driver's entrance and shipping office
- › Cross-dock facility

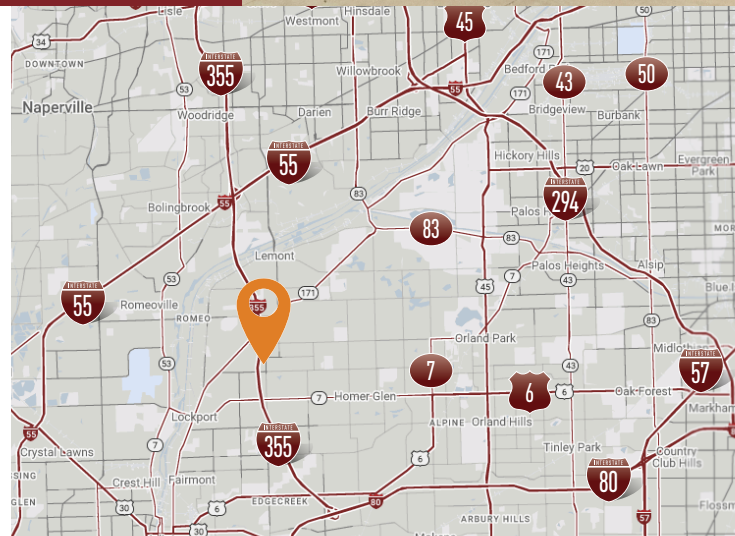

For More Information Contact

**NAI Hiffman**  
Commercial Real Estate Services, Worldwide

**HIFFMAN**  
NATIONAL

**DAN LEAHY, SIOR**

630-691-0604

dleahy@hiffman.com

**JOHN WHITEHEAD**

630-693-0643

jwhitehead@hiffman.com

**MARK MORAN**

630-693-0656

mmoran@hiffman.com

Owner:

ML Realty Partners \ \ One Pierce Place, Suite 450, Itasca, Illinois 60143 \ \ 630-250-2900

Information contained herein is subject to change and verification, and no liability for errors or omissions is assumed. © 2025 All Rights Reserved. ML Realty Partners

# Heritage Crossing #7

14746 S. Gougar Road, Lockport, IL



WEST 135TH STREET

FULL 4-WAY ACCESS

171

WEST 147TH STREET

← GOUGAR ROAD

WEST 151ST STREET

## Master Plan Rendering

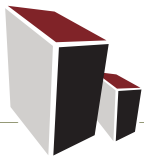
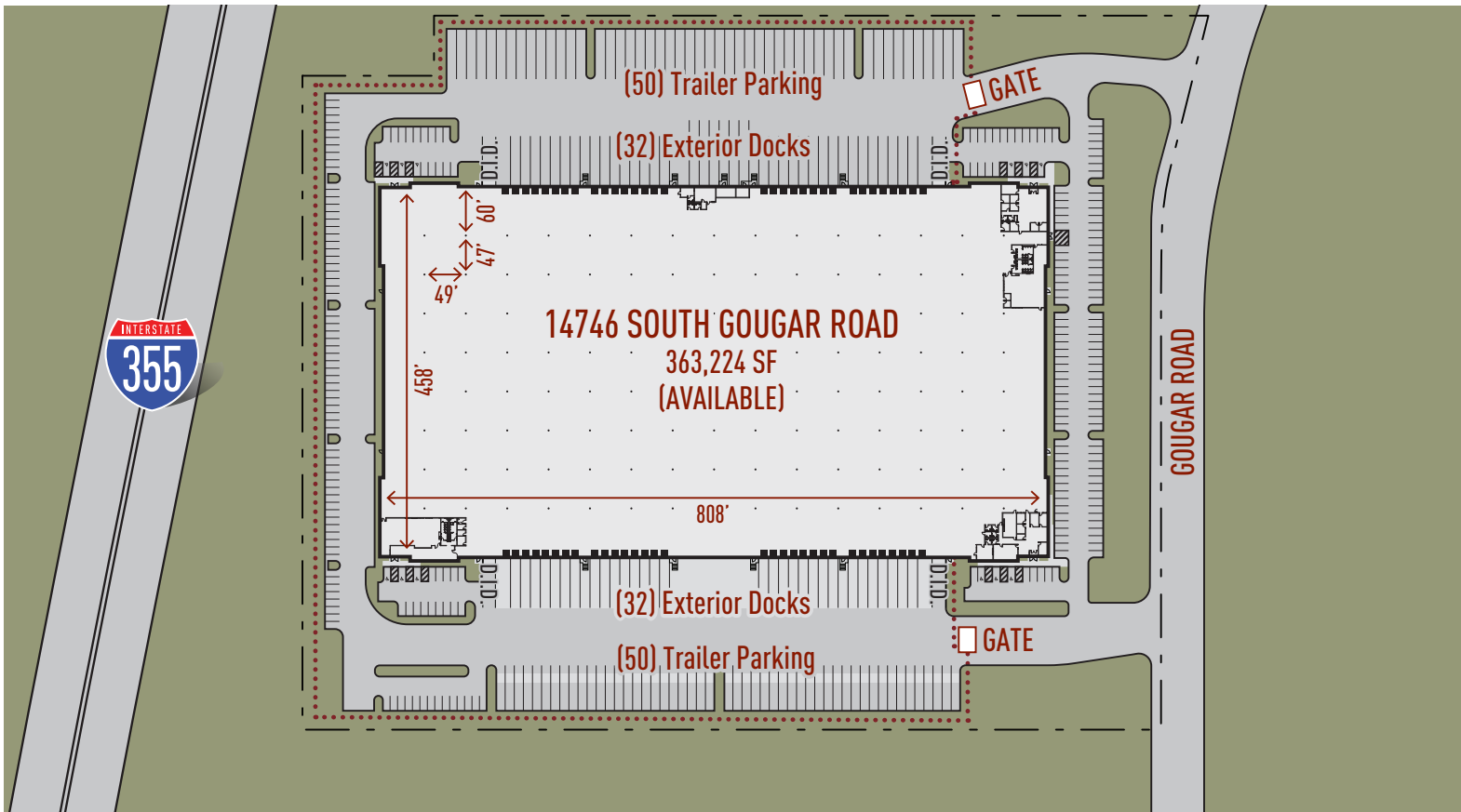

ML REALTY  
PARTNERS

NORTH ↑