

**2701 Busse Road
Elk Grove Village, IL**



143,552 SF AVAILABLE

Building Specifications

Building Size:	251,083 SF
Available:	143,552 SF
Office:	14,913 SF (Can Be Reduced)
Clear Height:	28' Clear
Loading:	17 Exterior Docks (Expandable)
Drive In Doors:	2
Electric:	600 Amps @ 480 Volts, 3-Phase
Car Parking:	92 Spaces
Column Spacing:	48' X 40'
Sprinkler System:	ESFR

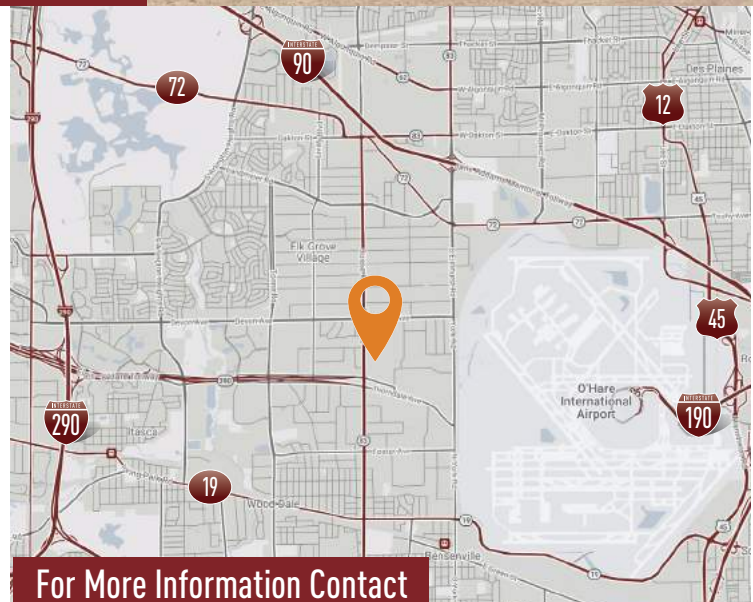

For More Information Contact

CBRE

KEVIN SEGERSON

847-585-0680

kevin.segerson@cbre.com

GENNA OHRN

630-368-5539

genna.ohrn@cbre.com

PHILIP DEBOER

847-706-4970

philip.deboer@cbre.com

Owner:

ML Realty Partners \ \ One Pierce Place, Suite 450, Itasca, Illinois 60143 \ \ 630-250-2900

Information contained herein is subject to change and verification, and no liability for errors or omissions is assumed. © 2024 All Rights Reserved. ML Realty Partners

Building Features

- › **DuPage County taxes**
- › Visibility on IL Route 83/Busse Road
- › Potential for 5 trailer parking stalls
- › Immediate access to I-390
- › 3 miles to O'Hare International Airport North Cargo Entrance
- › 3 miles to O'Hare International Airport South Cargo Entrance
- › 3.5 miles to I-290 via full interchange

2701 Busse Road, Elk Grove Village, IL

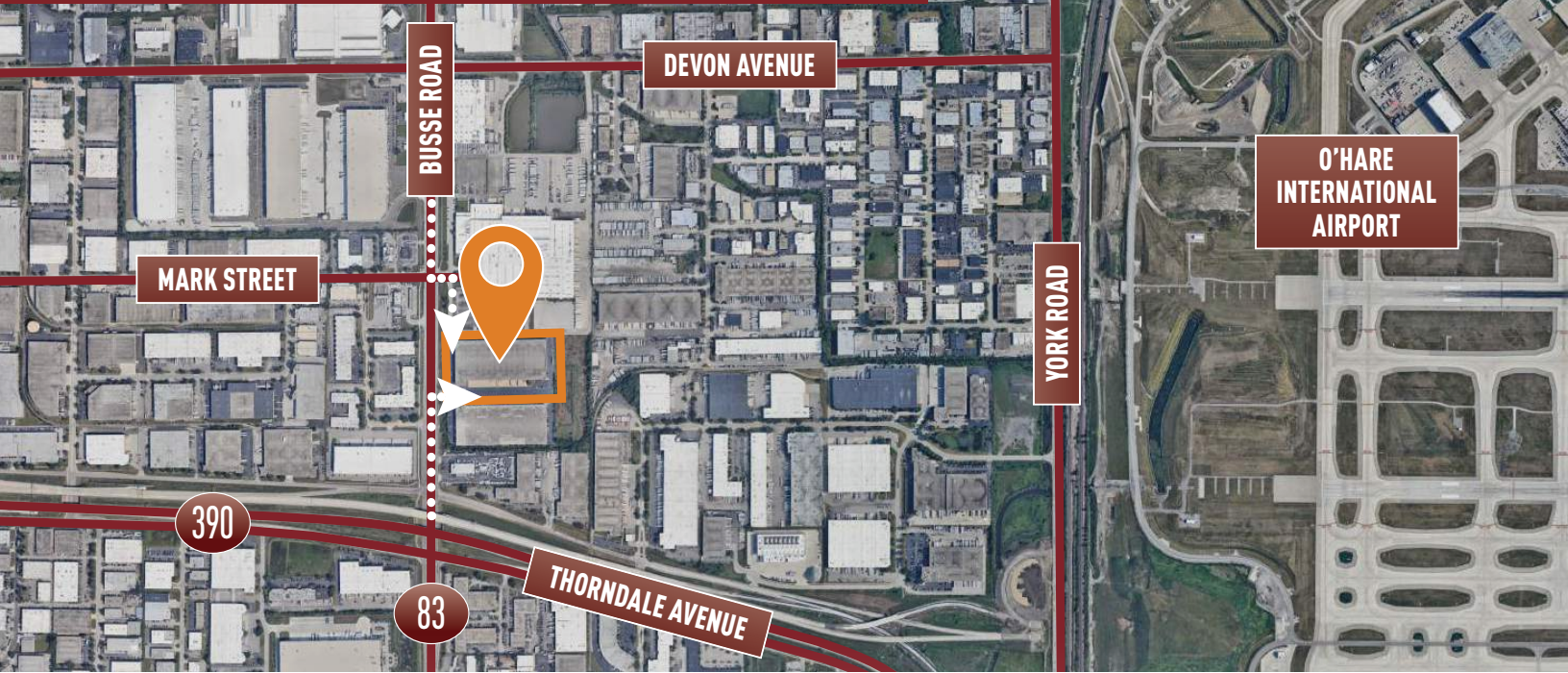

Site Plan Rendering

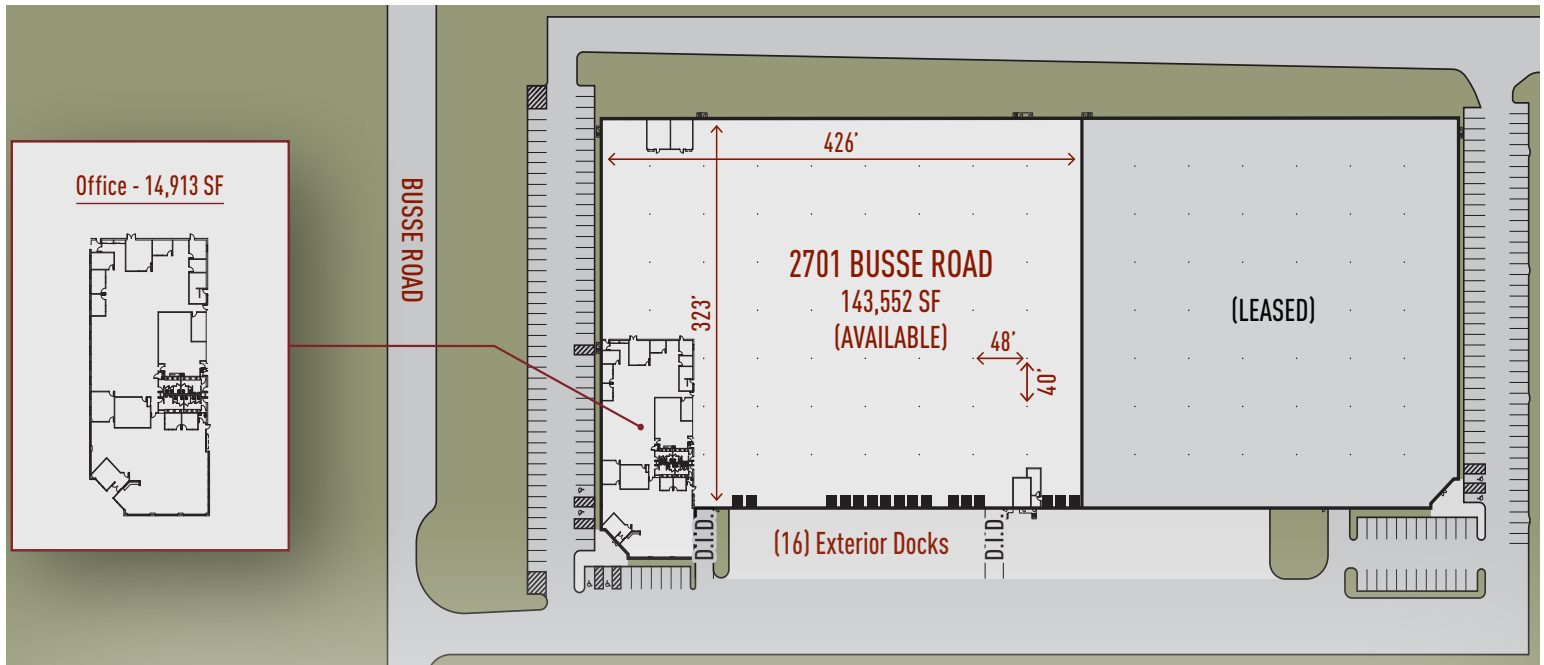

NORTH →



ML Realty Partners \ One Pierce Place, Suite 450, Itasca, Illinois 60143 \ 630-250-2900

Information contained herein is subject to change and verification, and no liability for errors or omissions is assumed. © 2024 All Rights Reserved. ML Realty Partners