

480 Wrangler Drive, Coppell, TX - Suite 300



ML REALTY
PARTNERS



8,113 SF AVAILABLE

**Park West
COMMERCE CENTER**

Building Specifications

Building Size:	57,019 SF
Available:	8,113 SF
Office:	2,552 SF
Clear Height:	22' Clear
Loading:	1 Dock High Door 1 Drive In Door (10' x 10')
Sprinkler System:	ESFR
Power:	400 Amps, 277/480 Volts, 3-Phase
HVAC:	100%

Building Features

- › Building located in Park West Commerce Center
- › Direct access to I-635, Hwy 121, Hwy 114, and George Bush turnpike
- › Direct access to DFW International Airport

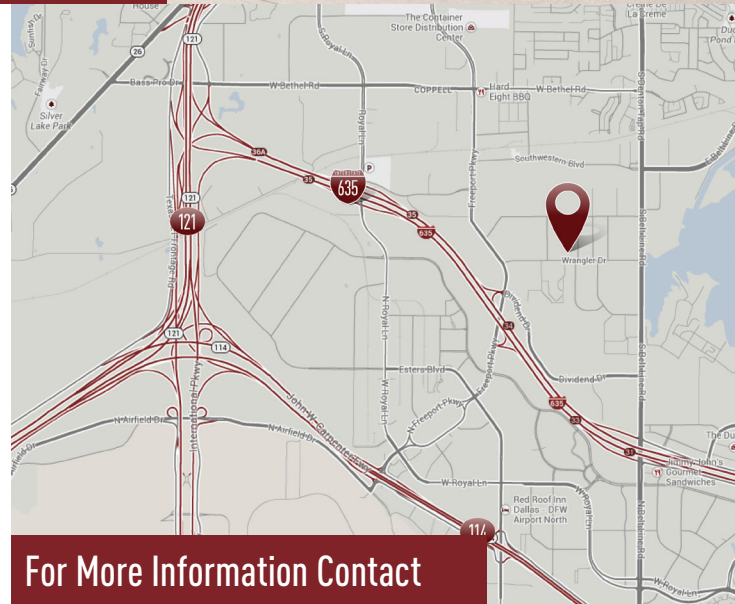

For More Information Contact

STREAM

JEREMY KELLY
469-767-2075
jkelly@streamrealty.com

LENA THOMAS
214-733-6787
lena.thomas@streamrealty.com

Owner:
ML Realty Partners \ 8150 N Central Expy, Suite M-2140, Dallas, TX 75206 \ 214-389-1155
Information contained herein is subject to change and verification, and no liability for errors or omissions is assumed. ©2024 All Rights Reserved. ML Realty Partners

480 Wrangler Drive, Coppel, TX - Suite 300

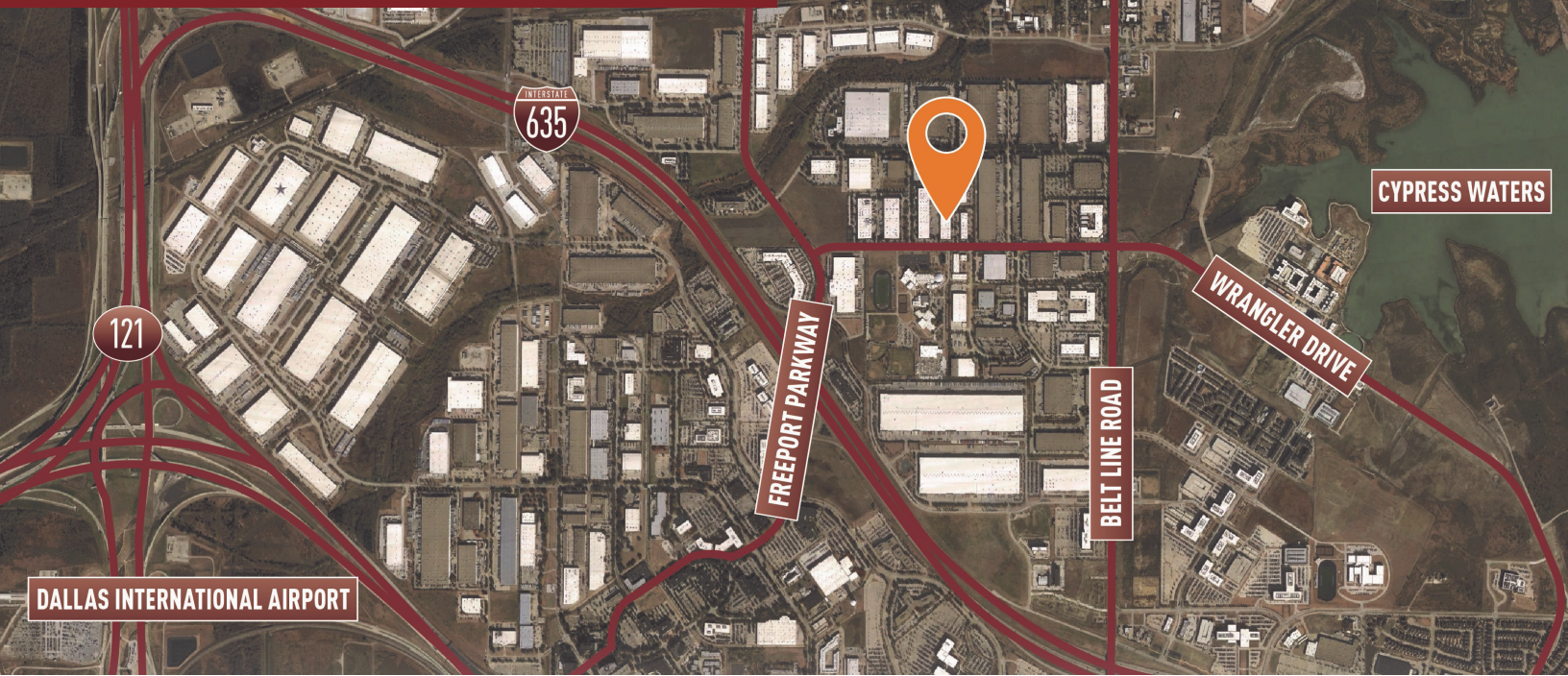

Master Plan Rendering

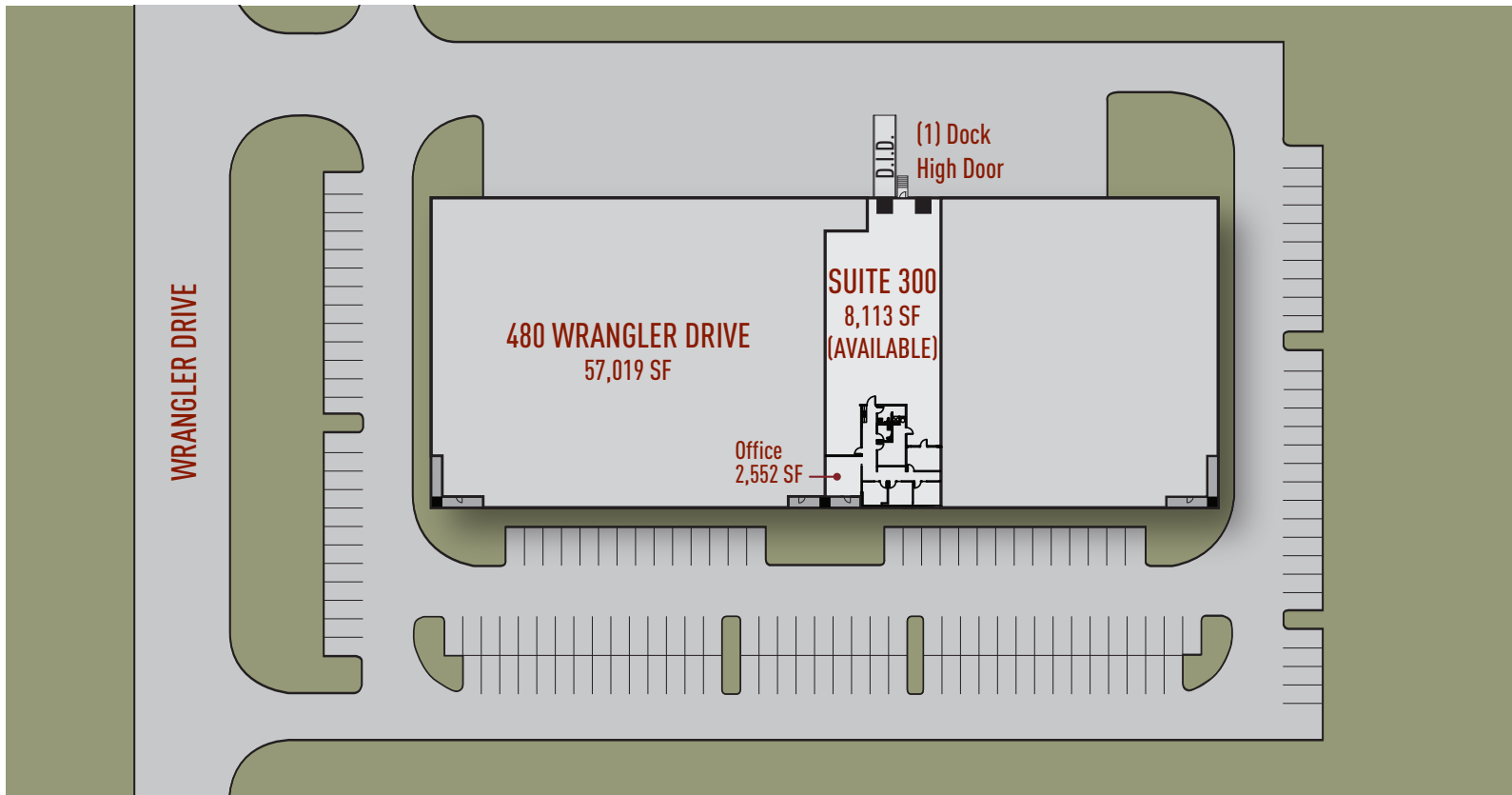

NORTH →



ML REALTY
PARTNERS

ML Realty Partners || 8150 N Central Expy, Suite M-2140, Dallas, TX 75206 || 214-389-1155

Information contained herein is subject to change and verification, and no liability for errors or omissions is assumed. © 2024 All Rights Reserved. ML Realty Partners